

Aluminium butt hinge SYS-AL13-2.1GL

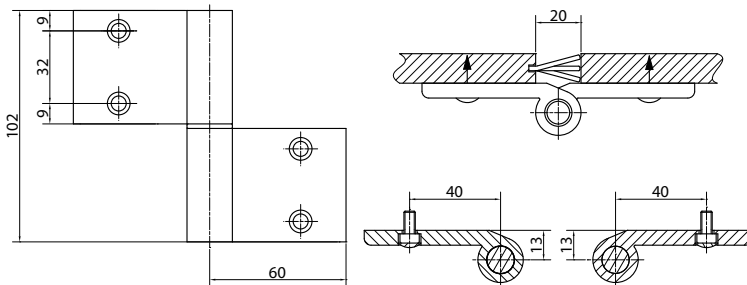

Technical facts

| | |
|-----------------------|---|
| Size: | 102,0 mm |
| Knuckle diameter: | 20 mm |
| Hinge pin diameter: | 12 mm |
| Hinge pin: | Stainless steel |
| Spring core: | Sleeve: steel galvanised, Spring: spring steel Stainless steel (additional charge) |
| Recommended fixation: | Door leaf: cylinder head screw (SS) M6 x 10 incl. screw cover (4 pieces included) |
| Packing unit: | 30 hinges |



Tender specification

SYSKO-Aluminium butt hinge Type: SYS-AL13-2.1GL for rebated or unrebated partition walls
 2-parts butt hinge for fixation to door leaf without cutout
 Hinge surface aluminium anodised or powder-coated
 Bush bearing in nylon to guide hinge pins
 Available as standard hinge (AL13-2.1GLS) or spring hinge (AL13-2.1GLF)
 Unhinge safety for spring hinge (additional charge)

| Article | Description | Order number |
|----------------------|--|--|
| AL13-2.1GLS DIN L | Standard hinge aluminium anodised | 84AL1321GLSEVL |
| AL13-2.1GLS DIN R | Standard hinge aluminium anodised | 84AL1321GLSEVR |
| AL13-2.1GLF DIN L | Spring hinge aluminium anodised | 84AL1321GLFEVL |
| AL13-2.1GLF DIN R | Spring hinge aluminium anodised | 84AL1321GLFEVR |
| AL13-2.1GLS DIN L | Standard hinge powder-coated (11 colours - colour chart enclosed) | 84AL1321GLS___L (Please specify RAL no.!) |
| AL13-2.1GLS DIN R | Standard hinge powder-coated (11 colours - colour chart enclosed) | 84AL1321GLS___R (Please specify RAL no.!) |
| AL13-2.1GLF DIN L | Spring hinge powder-coated (11 colours - colour chart enclosed) | 84AL1321GLF___L (Please specify RAL no.!) |
| AL13-2.1GLF DIN R | Spring hinge powder-coated (11 colours - colour chart enclosed) | 84AL1321GLF___R (Please specify RAL no.!) |
| Additional charge | Unhinge safety for spring hinge | MP84AUSH |
| Additional charge | Spring core, spring and sleeve in stainless steel | MP84FKES102 |

Notes
